

FOR 424, 430, 432 TRACTORS

Requires:

14712E1 Rear Hitch.

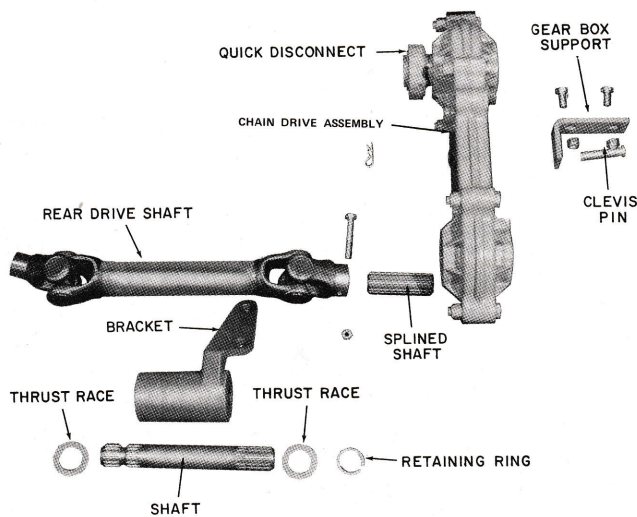

Figure 1

Lubrication:

Use general purpose grease in the bracket (Figure 1) to lubricate the shaft that fits under the axle. Use light oil on the quick disconnect of the chain drive assembly (Figure 1) before using. Clean and re-lubricate after each use. Use SAE 30 oil in the chain drive assembly. Fill chain drive assembly to bottom plug level holding the chain drive assembly vertical (quick disconnect to top). Check level periodically.

Assembly:

1. Check the Right Retaining Assembly of the rear hitch. On earlier hitches it will be necessary to obtain a new Right Retaining Assembly or drill 2 - 17/32 inch diameter holes as shown in Figure 2.

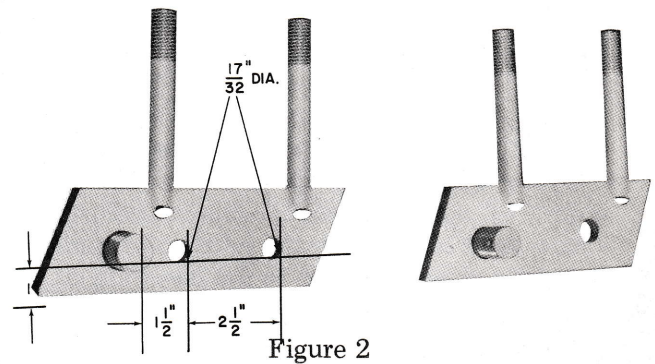

Figure 2

2. If not previously done, install the rear hitch on the tractor.

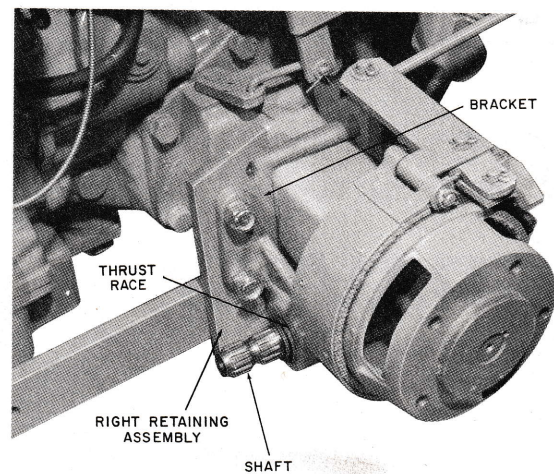

Figure 3

3. Place the flat thrust race on the shaft against the shoulder. Install the shaft through the bracket from the rear. Place the thrust race with the recess on the shaft, flat side next to the bracket. Secure in place with the retaining ring. Be sure the retaining ring is in the groove and under the retainer.

Install the bracket on the right retaining assembly as shown in Figure 3.

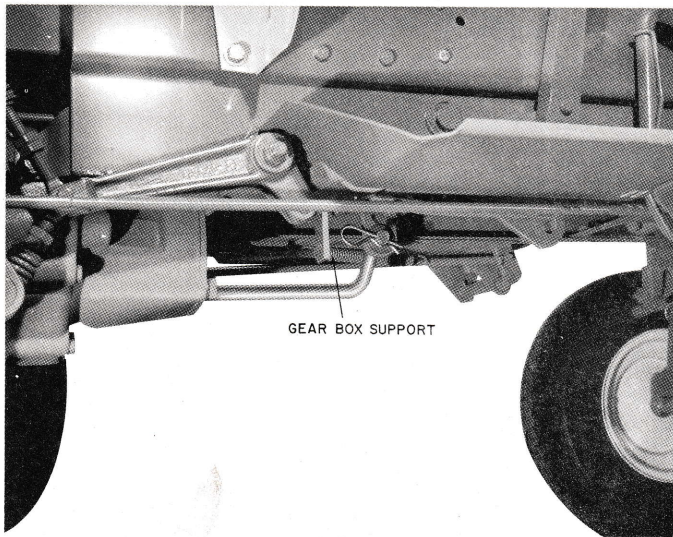

Figure 4

4. Two 11/32 inch diameter holes to mount the gear box support must be drilled in the tractor frame to initially mount the rear PTO. To locate these holes, turn the quick disconnect of the chain drive assembly in the direction of the arrow, install the chain drive assembly on the PTO of the tractor. Attach the gear box support to the front side of the chain drive assembly. Secure in place with clevis pin and hair pin cotter. Pivot unit to the right until the gear box support lays flat on the bottom flange of the frame and is pointing to the front of the tractor.

Mark the hole locations. Detach chain drive assembly from gear box support. Drill holes through frame. Secure the gear box support to the frame using bolts and locknuts.

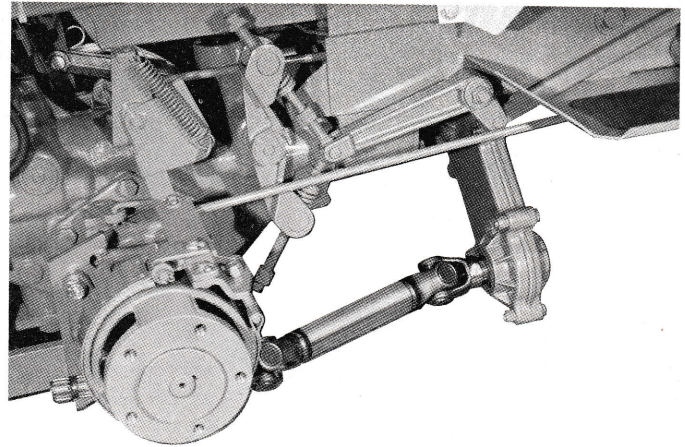

Figure 5

5. Mount the small splined shaft in the drilled end of the rear drive shaft. Secure in place with bolt and locknut.
6. Insert the splined shaft of the rear drive shaft in the lower (output) end of the housing. Pull chain drive housing over and slide free end of the rear drive shaft on the shaft through the bracket.
7. Attach the chain drive assembly to the gear box support with clevis pin, secure with hair pin cotter.

 **GRAVELY**

One Gravely Lane
Clemmons, N. C. 27012

Printed in U. S. A.